



INSTRUCTION MANUAL

20V CORDLESS COMPRESSOR & AIR PUMP

MODEL: RACCOMPKIT



BUILDER SAS

32, rue Aristide Bergès -ZI 31270 Cugnaux –France

MADE IN PRC



IMPORTANT: PLEASE READ THE INSTRUCTION MANUAL BEFORE USING.

CONTENTS

1. INTENDED USE.....	3
2. SAFETY INSTRUCTIONS.....	3
3. YOUR PRODUCT.....	9
4. SCOPE OF THE DELIVERY.....	11
5. TECHNICAL DETAILS.....	12
6. BEFORE USE.....	13
7. OPERATION THE 20V AIR PUMP.....	14
8. OPERATION THE 20V COMPRESSOR.....	15
9. CLEANING AND MAINTENANCE.....	16
10. STORAGE AND TRANSPORTATION.....	16
11. TROUBLESHOOTING.....	17
12. DISPOSAL.....	17
13. DECLARATION OF CONFORMITY.....	18
14. WARRANTY.....	19
15. PRODUCT FAILURE.....	20
16. WARRANTY EXCLUSIONS.....	21

1. INTENDED USE

20V compressor

The appliance is designed for pumping up bicycle tires and inflatable game, sport and beach articles; however, not for large-volume inflatables such as rubber dinghies and large inflatable mattresses. It is also suitable for measuring the current pressure. The pressure display is not calibrated. The compressor is not suitable for inflating car tires.

20V air pump

The appliance is designed for inflating and deflating inflatable mattresses, rubber dinghies, paddling pools and other large-volume inflatables for home use. It is not suitable for pumping up bicycle or car tires.

The appliances are not suitable for commercial use. Any other usage of our modification to the appliances is deemed to be improper and carries the risk of serious personal injury. The manufacturer accepts no responsibility for damage(s) attributable to misuse.

2. SAFETY INSTRUCTIONS



WARNING Read all safety warnings, instructions, illustrations and specifications provided with this power tool. Failure to follow all instructions listed below may result in electric shock, fire and/or serious injury.

Save all warnings and instructions for future reference.

The term "power tool" in the warnings refers to your mains-operated (corded) power tool or battery-operated (cordless) power tool.

1) Work area safety

- a) **Keep work area clean and well lit.** *Cluttered or dark areas invite accidents.*
- b) **Do not operate power tools in explosive atmospheres, such as in the presence of flammable liquids, gases or dust.** *Power tools create sparks which may ignite the dust or fumes.*
- c) **Keep children and bystanders away while operating a power tool.** *Distractions can cause you to lose control.*

2) Electrical safety

- a) **Power tool plugs must match the outlet. Never modify the plug in any way. Do not use any adapter plugs with earthed (grounded) power tools.** *Unmodified plugs and matching outlets will reduce risk of electric shock.*
- b) **Avoid body contact with earthed or grounded surfaces, such as pipes, radiators, ranges and refrigerators.** *There is an increased risk of electric shock if your body is earthed or grounded.*
- c) **Do not expose power tools to rain or wet conditions.** *Water entering a power tool will increase the risk of electric shock.*
- d) **Do not abuse the cord. Never use the cord for carrying, pulling or unplugging the power tool. Keep cord away from heat, oil, sharp edges or moving parts.** *Damaged or entangled cords increase the risk of electric shock.*
- e) **When operating a power tool outdoors, use an extension cord suitable for outdoor use.** *Use of a cord suitable for outdoor use reduces the risk of electric shock.*
- f) **If operating a power tool in a damp location is unavoidable, use a residual current device (RCD) protected supply.** *Use of an RCD reduces the risk of electric shock.*

3) Personal safety

- a) **Stay alert, watch what you are doing and use common sense when operating a power tool. Do not use a power tool while you are tired or under the influence of drugs, alcohol or medication.** *A moment of inattention while operating power tools may result in serious personal injury.*
- b) **Use personal protective equipment. Always wear eye protection.** *Protective equipment such as a dust mask, non-skid safety shoes, hard hat or hearing protection used for appropriate conditions will reduce personal injuries.*
- c) **Prevent unintentional starting. Ensure the switch is in the off-position before connecting to power source and/or battery pack, picking up or carrying the tool.** *Carrying power tools with your finger on the switch or energising power tools that have the switch on invites accidents.*
- d) **Remove any adjusting key or wrench before turning the power tool on.** *A wrench or a key left attached to a rotating part of the power tool may result in personal injury.*
- e) **Do not overreach. Keep proper footing and balance at all times.** *This enables better control of the power tool in unexpected situations.*
- f) **Dress properly. Do not wear loose clothing or jewellery. Keep your hair and clothing away from moving parts.** *Loose clothes, jewellery or long hair can be caught in moving parts.*
- g) **If devices are provided for the connection of dust extraction and collection facilities, ensure these are connected and properly used.** *Use of dust collection can reduce dust-related hazards.*
- h) **Do not let familiarity gained from frequent use of tools allow you to become complacent and ignore tool safety principles.** *A careless action can cause severe injury within a fraction of a second.*

4) Power tool use and care

- a) **Do not force the power tool. Use the correct power tool for your application.** *The correct power tool will do the job better and safer at the rate for which it was designed.*
- b) **Do not use the power tool if the switch does not turn it on and off.** *Any power tool that cannot be controlled with the switch is dangerous and must be repaired.*
- c) **Disconnect the plug from the power source and/or remove the battery pack, if detachable, from the power tool before making any adjustments, changing accessories, or storing power tools.** *Such preventive safety measures reduce the risk of starting the power tool accidentally.*
- d) **Store idle power tools out of the reach of children and do not allow persons unfamiliar with the power tool or these instructions to operate the power tool.**
Power tools are dangerous in the hands of untrained users.
- e) **Maintain power tools and accessories. Check for misalignment or binding of moving parts, breakage of parts and any other condition that may affect the power tool's operation. If damaged, have the power tool repaired before use.** *Many accidents are caused by poorly maintained power tools.*
- f) **Keep cutting tools sharp and clean.** *Properly maintained cutting tools with sharp cutting edges are less likely to bind and are easier to control.*
- g) **Use the power tool, accessories and tool bits etc. in accordance with these instructions, taking into account the working conditions and the work to be performed.** *Use of the power tool for operations different from those intended could result in a hazardous situation.*
- h) **Keep handles and grasping surfaces dry, clean and free from oil and grease.** *Slippery handles and grasping surfaces do not allow for safe handling and control of the tool in unexpected situations.*

5) Battery tool use and care

- a) **Recharge only with the charger specified by the manufacturer.** *A charger that is suitable for one type of battery pack may create a risk of fire when used with another battery pack.*
- b) **Use power tools only with specifically designated battery packs.** *Use of any other battery packs may create a risk of injury and fire.*
- c) **When battery pack is not in use, keep it away from other metal objects, like paper clips, coins, keys, nails, screws or other small metal objects, that can make a connection from one terminal to another.** *Shorting the battery terminals together may cause burns or a fire.*
- d) **Under abusive conditions, liquid may be ejected from the battery; avoid contact. If contact accidentally occurs, flush with water. If liquid contacts eyes, additionally seek medical help.** *Liquid ejected from the battery may cause irritation or burns.*
- e) **Do not use a battery pack or tool that is damaged or modified.** *Damaged or modified batteries may exhibit unpredictable behaviour resulting in fire, explosion or risk of injury.*
- f) **Do not expose a battery pack or tool to fire or excessive temperature.** *Exposure to fire or temperature above 130 °C may cause explosion.*

NOTE the temperature 130 °C can be replaced by the temperature 265 °F.

- g) **Follow all charging instructions and do not charge the battery pack or tool outside the temperature range specified in the instructions.** *Charging improperly or at temperatures outside the specified range may damage the battery and increase the risk of fire.*

6) Service

- a) **Have your power tool serviced by a qualified repair person using only identical replacement parts.** *This will ensure that the safety of the power tool is maintained.*
- b) **Never service damaged battery packs.** *Service of battery packs should only be performed by the manufacturer or authorized service providers.*

SPECIFIC SAFETY WARNINGS FOR COMPRESSOR AND AIR PUMP

- Do not use the compressor in potentially explosive rooms.
- Never leave the compressor unsupervised while it is in use.
- Caution! Operate the compressor only for a short time. The appliance may overheat if operated continuously for longer than 10 minutes. Switch the appliance off immediately and allow it to cool down for at least 10 minutes.
- Risk of injury! Do not pump any objects up to more than the intended pressure. They could burst and cause injury and/or material damage.
- Do not exceed the permissible output range of the compressor. Do not pump up any lorry, tractor or other large tires.
- Do not work with any material that are or could be easily inflammable or explosive.
- Never use the compressor and air pump for purposes other than the ones for which it was designed.
- The appliance must always be kept clean, dry and free from oil or grease.
- Never use gasoline or other inflammable liquids to clean the unit! Vapours remaining in the appliance could be ignited by sparks and lead to the explosion of the appliance!
- Remain alert at all times! Never use the appliance when you are distracted or don't feel well.
- The compressor and hoses can get very hot during operation. Touching them can cause burns.
- The gases or vapours sucked in by the compressor intake must be kept free of admixtures that could lead to fires or explosions inside the compressor.

- When removing the hose coupling, always hold the hose coupling firmly to avoid injury caused by the hose flying off.
- Check all connections. All units, couplings and hoses must correspond to the appliance parameters in terms of pressure and air flow. Excessively low pressure will adversely affect the functions of the appliance; excessively high pressure can cause property damage and personal injury. Protect the hoses against kinking, solvents and sharp edges.
- Ensure that the hose clamps are always tight. Loose or damaged hose clamps can allow air to escape in an uncontrolled manner.
- Replace a damaged hose immediately. A faulty supply line can cause a compressed-air hose to thrash about and cause personal injury.
- Do not breathe in the exhaust air directly.
- The hose must be designed for at least 150% of the maximum pressure generated in the system.
- The tool and the supply hose must be fitted with a hose coupling that allows the pressure of the coupling hose to be dispersed completely during disconnection.
- **WARNING!** An undersized compressed air system will reduce the efficiency of your appliance.
- Avoid getting exhaust air in your eyes. The exhaust air from the appliance may contain water, oil, metal particles or impurities from the compressor. This can cause damage to health.
- Do not direct the jet of air towards persons, animals or your body.
- Keep animals at a distance from the work area
- Do not cover the air inlets on the compressor and air pump.
- Do not open or tamper with any part of the compressor and air pump. Contact an authorized service center.
- Wear ear protector. Exposure to noise can cause hearing loss.

SAFETY INSTRUCTIONS FOR BATTERIES AND CHARGER

Batteries

- Never attempt to open for any reason.
- Do not store in locations where the temperature may exceed 40°C (104°F).
- Charge only at ambient temperatures between 4°C and 40°C (39.2°F and 104°F).
- Charge only using the charger provided with the tool.
- Store your batteries in a cool dry place (5°C-20°C/41°F-68°F). Never store batteries in discharged state.
- It is better for Li-ion batteries to discharge and reload them regularly (at least 4 times a year). The ideal charge for long-term storage of your Li-ion battery is 40% of capacity.
- When disposing of batteries, follow the instructions given in the section “Protecting the environment”.
- Do not cause short circuits. If connection is made between the positive (+) and negative (-) terminal directly or via accidental contact with metallic objects, the battery is short circuited and an intense current will flow causing heat generation which may lead to casing rupture or fire.
- Do not heat. If batteries are heated to above 100°C (212°F), sealing and insulating separators and other polymer components may be damaged resulting in electrolyte leakage and/or internal short circuiting leading to heat generation causing rupture or fire. Moreover do not dispose of the batteries in fire, explosion and/or intense burning may result.

- Under extreme conditions, battery leakage may occur. When you notice liquid on the battery, proceed as follows:
 - ✓ Carefully wipe the liquid off using a cloth. Avoid skin contact.
 - ✓ In case of skin or eye contact, follow the instructions below:
 - Immediately rinse with water. Neutralize with a mild acid such as lemon juice or vinegar.
 - In case of eye contact, rinse abundantly with clean water for at least 10 minutes. Consult a physician.



Fire hazard! Avoid short-circuiting the contacts of a detached battery. Do not incinerate the battery.

Charger

- Use the charger provided with the tool only to charge the battery.
- Never attempt to charge non-rechargeable batteries.
- Have defective cords replaced immediately.
- Do not expose to water.
- Do not open the charger.
- Do not probe the charger.
- The charger is intended for indoor use only.
- This charger can be used by children aged from 8 years and above and persons with reduced physical, sensory or mental capabilities or lack of experience and knowledge if they have been given supervision or instruction concerning use of the appliance in a safe way and understand the hazards involved.
- Children shall not play with the appliance. Cleaning and user maintenance shall not be made by children without supervision.
- If the supply cord is damaged, it must be replaced by the manufacturer, its service agent or similarly qualified persons in order to avoid a hazard.

CAUTION: Do not recharge non-rechargeable batteries.

Residual Risk











Even if properly operating and handling this product in accordance with all the safety requirements, potential

risks of injury and damage remain. Due to its construction, this tool may present the following hazards:

- a) Electric shock from insufficient insulation. Do not use the product when the product or your hands are damp or wet.
- b) Ear damage if working without ear protection.
- c) There is a risk of short-circuit due to liquid penetrating the housing. Do not immerse the product and the accessories in water. And make sure that no water or other liquid can enter the housing.
- d) Damage to your health caused by swinging your hands and arms when operating the tool for longer periods of time or if the tool is not held or maintained properly.

⚠ Warning! During operating, the product generates an electromagnetic field which, under certain circumstances, may impair the functionality of active or passive medical implants. To reduce the risk of serious or lethal injuries, we recommend that persons with medical implants consult their doctor and the manufacturer of their medical implant before operating the electric tool.

Symbols description

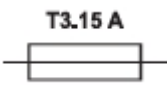
	Conforms to relevant safety standards
	To reduce the risk of injury, the user must read and understand this manual before using this product.
	Wear ear protectors. Exposure to noise can cause hearing loss.
	Warning: risk of high temperature
	Class II, double isolation (only for charger)
	Do not dispose of old appliances with domestic rubbish
	Do not expose the charger or the battery to water.
	Do not incinerate the battery or charger.
	Ambient temperature of 50 ° C max. (only for the battery)
	Use the battery and charger Indoor use only.
	Miniature fuse

3. YOUR PRODUCT

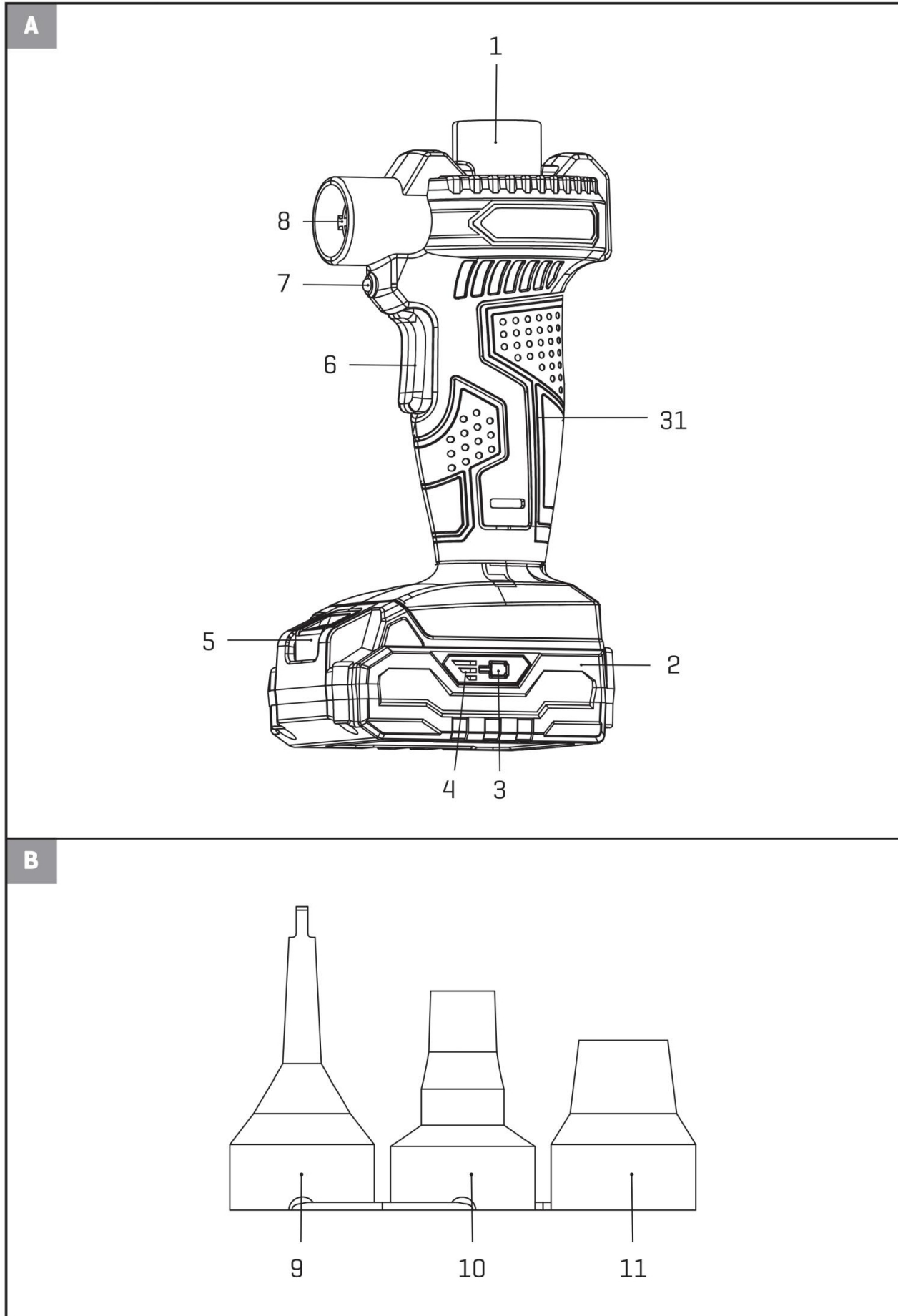

C

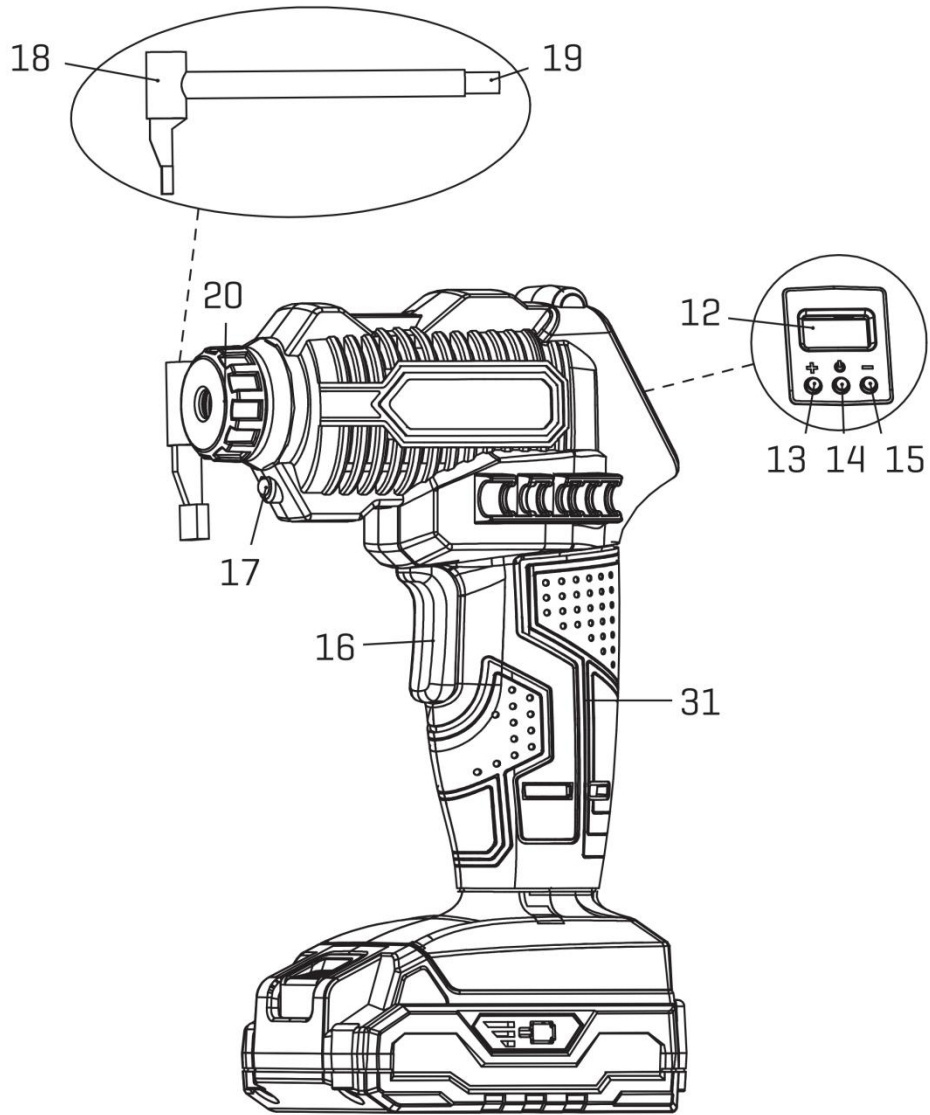

D

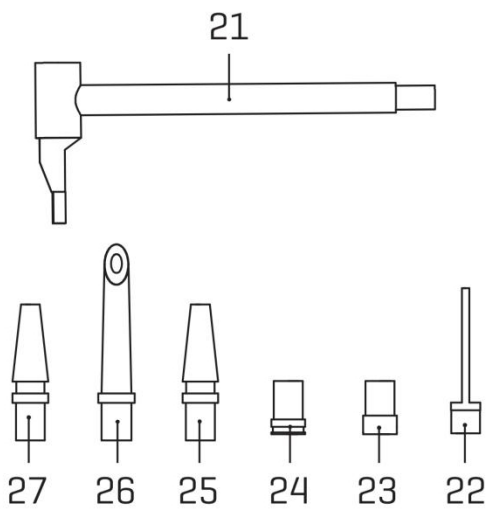

E

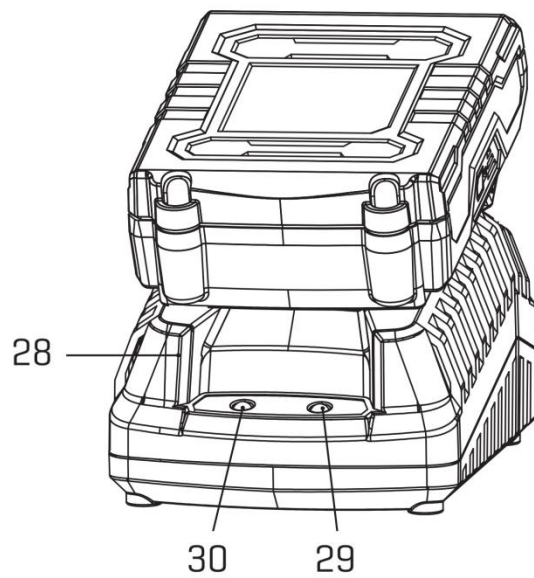

- | | |
|---|---|
| 1. Air inlet | 17. LED work lamp |
| 2. Battery pack | 18. Compressed air hose adapter |
| 3. Battery charge level button | 19. Compressed air hose threaded connection |
| 4. Battery level indication (LED) | 20. Nut |
| 5. Battery release button | 21. Compressed air hose |
| 6. ON/OFF switch | 22. Ball needle |
| 7. LED work lamp | 23. Valve adapter |
| 8. Air outlet | 24. Valve adapter |
| 9. Adaptor nozzle | 25. Universal adapter |
| 10. Adaptor nozzle | 26. Universal adapter |
| 11. Adaptor nozzle | 27. Universal adapter |
| 12. Display indicator on 20V compressor | 28. Charger |
| 13. "+" button | 29. RED Charge control LED |
| 14. ON/OFF button on the display | 30. GREEN charge control LED |
| 15. "-" button | 31. Handle |
| 16. ON/OFF switch | |

4. SCOPE OF THE DELIVERY

Carefully unpack and check that it is complete:

- 1x Battery-operated compressor
- 1x hose with valve adapter
- 2X inner-tube valves (1x Dunlop / express valve, 1x Presta valve)
- 1x ball needle
- 3x universal adapters
- 1x Battery-operated air pump
- 1x Universal adapter for valves with an internal diameter of approximated 8mm
- 1x adapter screw valve for bathing boats
- 1x adapter for deflation valves
- 1x carry case
- 1x battery pack 2.0Ah
- 1x battery charger
- 1x Instruction manual

5. TECHNICAL DETAILS

20V compressor	
Rated voltage	20V d.c.
Max. Pressure:	7 bar (100 psi)
Weight (without charger)	1.2kg
Noise measurement value determined in accordance with EN 62841	
LPA	85dB(A)
Uncertainty K	3dB
LWA	96dB(A)
Uncertainty K	3dB
Vibration value determined in accordance with EN 62841	
ah	2.6m/s ²
Uncertainty K	1.5 m/s ²
20V air pump	
Rated voltage	20V d.c.
Weight (without charger)	1.0kg
Air flow rate	70m ³ /h
Noise measurement value determined in accordance with EN 62841	
LPA	82dB(A)
Uncertainty K	3dB
LWA	93dB(A)
Uncertainty K	3dB
Vibration value determined in accordance with EN 62841	
ah	0.3
Uncertainty K	1.5 m/s ²
Battery pack	RACCOMPKIT
Type	Li-ion
Rated voltage	20V d.c.
capacity	2.0Ah (40Wh)
Quick charger	RACCOMPKIT
Rated input	230-240Va.c., 50Hz
Power consumption	65W
Rated output	21.5V d.c.
Charging current	2.4A
Charging time	Approx. 60min
Protection class	II

Information

- The declared vibration total value has been measured in accordance with a standard test method and may be used for comparing one tool with another;
- The declared vibration total value may also be used in a preliminary assessment of exposure.

Warning

- that the vibration emission during actual use of the power tool can differ from the declared total value depending on the ways in which the tool is used; and
- of the need to identify safety measures to protect the operator that are based on an estimation of exposure in the actual conditions of use (taking account of all parts of the operating cycle such as the times when the tool is switched off and when it is running idle in addition to the trigger time).

Wear hearing protection.

6. BEFORE USE

Unpacking

- 1) Unpack all parts and lay them on a flat stable surface.
- 2) Make sure the delivery contents are complete and free of damage. If you find that parts are missing or show damage, do not use the product but contact your dealer or the service center. Do not use the product unless missing parts have been delivered in addition or defective parts have been replaced. Using an incomplete or damaged product represents a hazard to people and property.
- 3) Ensure that you have all the accessories needed for assembly and operation.

Charging the battery pack

Note

- The battery can be damaged in case of improper charging.
- Remove the charger's mains plug before inserting or removing the battery.

The battery is partially charged upon delivery to avoid damage to the battery caused by a deep discharge. Prior to initial start-up and when the battery is low, the battery should be charged. To do so, please proceed as follows (Fig. E):

- 1) Slide the battery pack (2) onto the charger (28) upside down till it locks in place.
- 2) Insert the mains plug of the charger (28) into a properly fused mains socket. The RED charge control LED (29) is illuminated; and charging requires approx. 60min.
- 3) Wait until the RED charge control LED (29) goes out and green charge control LED (30) is illuminated, the battery is fully charged
- 4) Hold onto the mains plug while pulling the power cable of the charger out of the mains socket. The battery pack (2) and the charger (28) may have become warm during charging, allow the battery cool down to room temperature.
- 5) Take the battery pack (2) out of the charger (28) by pressing and holding the battery release button (5) and pulling the battery pack (2) out of the charger (28).

Removing /inserting the battery

- 1) To remove the battery pack (2) from the tool, press the battery release button (5) on the battery pack (2) and pull the battery out.
- 2) To insert the battery pack (2), place it on a guide track and push it back into the tool. It will audibly snap in.

Checking the battery charging level

The battery comes with an integrated battery level indication.

Press on the battery charge level button (3) on the battery pack (2). You can read the battery status from the battery level indication (LED) (4).

7. OPERATION THE 20V AIR PUMP

This appliance is not designed for continuous operation. It may be used for a maximum of 20 minutes. If the appliance overheats, remove the battery pack, allow the appliance to cool down completely and then try to use it again.

Inflation

- Remove the valve cap of the item you want to inflate.
- Fit the appropriate adapter nozzle (9), (10), or (11) on to the pump air outlet (8).
- Push the adapter nozzle (9), (10), or (11) into the valve of the item to be inflated.
- Turn on the appliance by pressing the ON/OFF switch (6).
- When the desired fill volume has been reached, switch off the appliance by pressing the ON/OFF switch (6) again.
- Now remove the adapter nozzle (9), (10), or (11).
- Replace the valve cap on the item that you have inflated.

Deflation

- Fit the appropriate adapter nozzle (9), (10), or (11) onto the pump air inlet (1).
- Remove the valve cap of the item you want to deflate and push the adapter nozzle (9), (10), or (11) into the valve of the item to be deflated.
- Switch the appliance on by pressing the ON/OFF switch (6).
- Once the item is fully deflated, switch off the appliance by pressing ON/OFF switch (6) again.
- Now remove the adapter nozzle (9), (10), or (11).

Adapters

- Adapter nozzle (9): For standard valves with an internal diameter of 8mm.
- Adapter nozzle (10): For inflatable items with a screw valve. Deflation is only possible with an unscrewed valve and with this adapter.
- Adapter nozzle (11): For inflatable items with a deflation valve.

NOTE: The LED work lamp (7) lights up as soon as you press the ON/OFF switch (6). This allows illumination of the working area while inflating in low light conditions; when switch off the product, the LED work lamp turns off accordingly.

8. OPERATION THE 20V COMPRESSOR

This appliance is not designed for continuous operation. It may be used for a maximum of 10 minutes. If the appliance overheats, remove the battery pack, allow the appliance to cool down completely and then try to use it again.

Display indicator

- Press the ON/OFF button on the display (14) to switch on the display indicator (12).
- The last set pressure is display for 2 seconds.
- After two seconds, the current pressure of the connected item is shown.

NOTE: If the compressed air hose is not connected to a suitable item, the display indicator (12) shows "0".

- If the display indicator (12) is switched on, you can switch between "Bar" and "psi" by pressing the ON/OFF button (14).
- To switch off the display indicator (12), press the ON/OFF button (14) for 3 seconds.

NOTE: The compressor will not work if the display indicator is switched off.

NOTE: The LED work lamp (17) lights up as soon as you press the ON/OFF switch (6). This allows illumination of the working area while inflating in low light conditions; when switch off the product, the LED work lamp turns off accordingly.

Setting the Pressure

- Hold down the "+" (13) or "-" (15) button till the display flashes.
- Press the "+" (13) or "-" (15) button to set the desired pressure.
- Once you see the desired pressure on the display indicator (12), do not press any button for about 3 seconds.
- The desired pressure is now set.

NOTE: The display indicator (12) (and thus the compressor switches off after about 3 minutes of inactivity).

Initial Operation

- Loosen the union nut (20) (do not unscrew it completely), twist in the compressed air hose threaded connection (19) and tighten the union nut (20).
- Select the desired pressure.
- Insert one of the supplied adapters (22-27) tightly onto the compressed air hose adapter (18).
- Connect the adapter or to the object to be inflated.
- Press the ON/OFF switch (16).
- The compressor switches off automatically when you reach the preset pressure.
- Pull the adapter out of the inflated item.

Adapters (22-27)

- Ball needle (22): the ball needle can be used to inflate various balls.
- Valve adapter (23): the Presta valve can be used for inflating bicycle tires.
- Valve adapter (24): the Dunlop valve can be used for inflating bicycle tires.
- Universal adapter (25): the universal adapter can be used to inflate air mattresses or similar.
- Universal adapter (26): for inflating pool toys, etc.
- Universal adapter (27): the universal adapter can be used to inflate air mattresses or similar.

9. CLEANING AND MAINTENANCE

WARNING!

Risk of injury; always switch the appliance off and remove the battery pack before carrying out any work on the product.

- Repair and servicing work not described in this manual should always be carried by our service center. Use only original parts.
- The appliance must always be kept clean, dry and free from oil or grease.
- Use a soft, a slightly moist cloth to clean the housing.
- Keep the product and ventilation slots clean at all times. If the ventilation slots are blocked, there is a risk of overheating and / or the appliances being damaged.
- Always clean the appliances after completion of work.
- Never permit liquids to enter inside the product. Never use petrol, solvents or cleansers which can damage the plastic.
- If the battery is to be stored for an extended period, the charge level should be checked regularly. The optimum charge level is between 50% and 80%. The optimum storage environment is cool and dry.



WARNING!

Only use accessories and additional equipment specified in the operating manual.

Using insertion tools or accessories other than those specific in the operating manual may cause a risk of injury. Only get the accessories from the Service Centre.

10. STORAGE AND TRANSPORTATION

Storage

- Switch the appliances off and remove the battery pack (2).
- Clean the product as described.
- Always ensure the attachments are clean, free of dust before storing.
- Store the product and its accessories in a dark, dry, frost-free, well-ventilated place.
- Always store the product in a place that is inaccessible to children.
- During a longer storage period, check the state of charge of the battery and recharge if necessary roughly every 3 months.
- We recommend using the original package for storage or covering the product with a suitable cloth or enclosure to protect it against dust.
- Regularly check the charge level of the battery pack (2), if it is to be stored for an extended period. Optimum storage conditions are cool and dry.

Transportation

- Switch the appliances off and remove the battery pack (2).
- Always carry the appliance by its handle.
- Protect the product from any heavy impact or strong vibrations which may occur during transportation in vehicles.
- Secure the appliances to prevent it from slipping or falling over.

11. TROUBLESHOOTING



WARNING!

Only perform the steps described within these instructions. All further inspection, maintenance and repair work must be performed by an authorized service center or a similarly qualified specialist if you cannot solve the problem yourself. Suspected malfunctions are often due to causes that the users can fix themselves. Therefore check the appliances using this section. In most cases the problem can be solved quickly.

Problem	Possible cause	Corrective action
Product do not start	Battery pack discharged	Recharge the battery
	Battery pack not inserted	Insert the battery pack
	ON/OFF switch cannot be pressed properly or defective	Send to the service center for repair
Different charging time	The battery pack is only partly charged	Re-charge the battery pack
	Battery pack is very cold or hot	Allow the battery pack to return the normal ambient temperature, then recharge
Short battery working time	The battery pack is not fully charged	Fully charge the batter pack
The air could not get in	The hose or attachments are not connected well	Check the connection of the hose and attachment.

Note: if your product does not operate correctly after these checks, please contact the Service Center.

12. DISPOSAL



Electrical products should not be discarded with household products. According to the European Directive 2012/19/EU on waste electrical and electronic equipment and its implementation into national law, electrical products used must be collected separately and disposed of at collection points provided for this purpose. Talk with your local authorities or dealer for advice on recycling.



Li-ion

Environmental damage through incorrect disposal of the batteries / rechargeable batteries

Remove the battery pack from the product before disposal. Batteries /rechargeable batteries may not be disposed of with the usual domestic waste. They may contain toxic heavy metals and are subject to hazardous waste treatment rules and regulations. Please dispose of batteries according to the relevant local requirements.

13. DECLARATION OF CONFORMITY

**BUILDER SAS****32, rue Aristide Bergès - ZI 31270 Cugnaux - France**, declares that,

Product: Cordless 20V Compressor / 20V Air pump

Trademark: RACING

Model: RACCOMPKIT

Serial number: [20210666474-20210672773](#)

is in conformity with the essential requirements and other relevant provisions of the applicable European Directives, based on the application of European harmonized standards. Any unauthorized modification of the apparatus voids this declaration.

European Directives (including, if applicable, their amendments up to the date of signature);

RoHS directive 2011/65/EU + (EU) 2015/863

Directive Machine 2006/42/EC

Directive EMC 2014/30/UE

LVD Directive 2014/35/UE

European harmonized standards (including, if applicable, their amendments up to the date of signature);

EN ISO 12100:2010

EN 62841-1:2015

EN 55014-1:2006+A1:2009+A2:2011

EN 55014-1:2017

EN 55014-2:2015

EN 61000-3-2:2014

EN 61000-3-3:2013

EN 60335-1:2012+A11:2014

EN 60335-2-29: 2004+A2:2010

EN 62233:2008

Cugnaux, [01/03/2021](#)

Philippe MARIE / PDG

Responsible of the technical file: Mr. Olivier Patriarca

15. PRODUCT FAILURE

WHAT TO DO IF MY MACHINE BREAKS DOWN?

If you bought your product in a store:

- a) Empty the fuel tank if your product has one.
- b) Make sure that your machine is complete with all accessories supplied, and clean! If this is not the case, the repairer will refuse the machine.

Go to the store with the complete machine and with the receipt or invoice.

If you bought your product on a website:

- a) Empty the fuel tank if your product has one.
- b) Make sure that your machine is complete with all accessories supplied, and clean! If this is not the case, the repairer will refuse the machine.
- c) Create a SWAP-Europe service ticket on the site: <https://services.swap-europe.com> When making the request on SWAP-Europe, you must attach the invoice and the photo of the nameplate (serial number).
- d) Contact the repair station to make sure it is available before dropping off the machine.

Go to the repair station with the complete machine packed, accompanied by the purchase invoice and the station support sheet downloadable after the service request is completed on the SWAP-Europe site

For machines with engine failure from manufacturers BRIGGS & STRATTON, HONDA and RATO, please refer to the following instructions.

Repairs will be done by approved engine manufacturers of these manufacturers, see their site:

- <http://www.briggsandstratton.com/eu/fr>
- <http://www.honda-engines-eu.com/fr/service-network-page;jsessionid=5EE8456CF39CD572AA2AEEDFD290CDAE>
- <https://www.rato-europe.com/it/service-network>

Please keep your original packaging to allow for after-sales service returns or pack your machine with a similar cardboard box of the same dimensions.

For any question concerning our after-sales service you can make a request on our website <https://services.swap-europe.com>

Our hotline remains available at +33 (9) 70 75 30 30.



16. WARRANTY EXCLUSIONS

THE WARRANTY DOES NOT COVER:

- Start-up and setting up of the product.
- Damage resulting from normal wear and tear of the product.
- Damage resulting from improper use of the product.
- Damage resulting from assembly or start-up not in accordance with the user manual.
- Breakdowns related to carburetion beyond 90 days and fouling of carburetors.
- Periodic and standard maintenance events.
- Actions of modification and dismantling that directly void the warranty.
- Products whose original authentication marking (brand, serial number) has been degraded, altered or withdrawn.
- Replacement of consumables.
- The use of non-original parts.
- Breakage of parts following impacts or projections.
- Accessories breakdowns.
- Defects and their consequences linked to any external cause.
- Loss of components and loss due to insufficient screwing.
- Cutting components and any damage related to the loosening of parts.
- Overload or overheating.
- Poor power supply quality: faulty voltage, voltage error, etc.
- Damages resulting from the deprivation of enjoyment of the product during the time necessary for repairs and more generally the costs related to the immobilization of the product.
- The costs of a second opinion established by a third party following an estimate by a SWAP-Europe repair station
- The use of a product which would show a defect or a breakage which was not the subject of an immediate report and/or repair with the services of SWAP-Europe.
- Deterioration linked to transport and storage*.
- Launchers beyond 90 days.
- Oil, petrol, grease.
- Damages related to the use of non-compliant fuels or lubricants.

* In accordance with transport legislation, damage related to transport must be declared to carriers within 48 hours maximum after observation by registered letter with acknowledgement of receipt.

This document is a supplement to your notice, a non-exhaustive list.

Attention: all orders must be checked in the presence of the delivery person. In case of refusal by the delivery person, it you must simply refuse the delivery and notify your refusal.

Reminder: the reserves do not exclude the notification by registered letter with acknowledgement within 72 hours.

Information:

Thermal devices must be wintered each season (service available on the SWAP-Europe site). Batteries must be charged before being stored.